

## QUICK-CORNER BLOCK

1. Mark a diagonal line on the wrong side of each **B4** square.
2. Place one **B4** square on the **top RIGHT corner**, RST, of each of the four **C10** rectangles.
3. Sew on the diagonal line.
4. Trim corner  $\frac{1}{4}$ " from the seam and press toward fabric B.
5. Trim to 3" x 8" if needed.

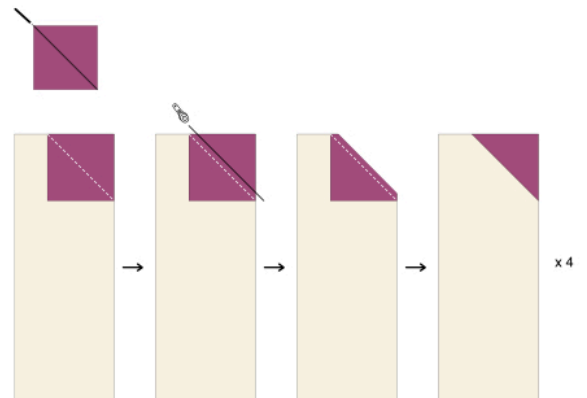

These blocks will be referred to as **Quick-Corner 1**.

6. **Repeat** steps 2 to 4, placing each remaining **B4** square on the **top LEFT corner**, RST, of each of the four **C9** rectangles.
7. Trim to 3" x 5  $\frac{1}{2}$ " if needed.

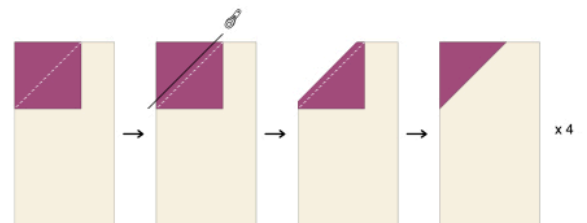

These blocks will be referred to as **Quick-Corner 2**.